

LuxteL[®] llc

CeraLux[®] Xenon Arc Lamps

CeraLux Xenon Lamp - C Style Body Size

LuxteL now offers an alternative lamp design to other C size ceramic lamps. Our C body size lamp is compatible with that of PerkinElmer, yet provides an improved cooling design.

We will show you how easy it is to use your existing hardware, re-trofit with ours or customize your own design to optimize your system's performance.

Our CeraLux brand is offered in varying power levels with two elliptical reflector designs, to assure you have the right lamp for the right application.

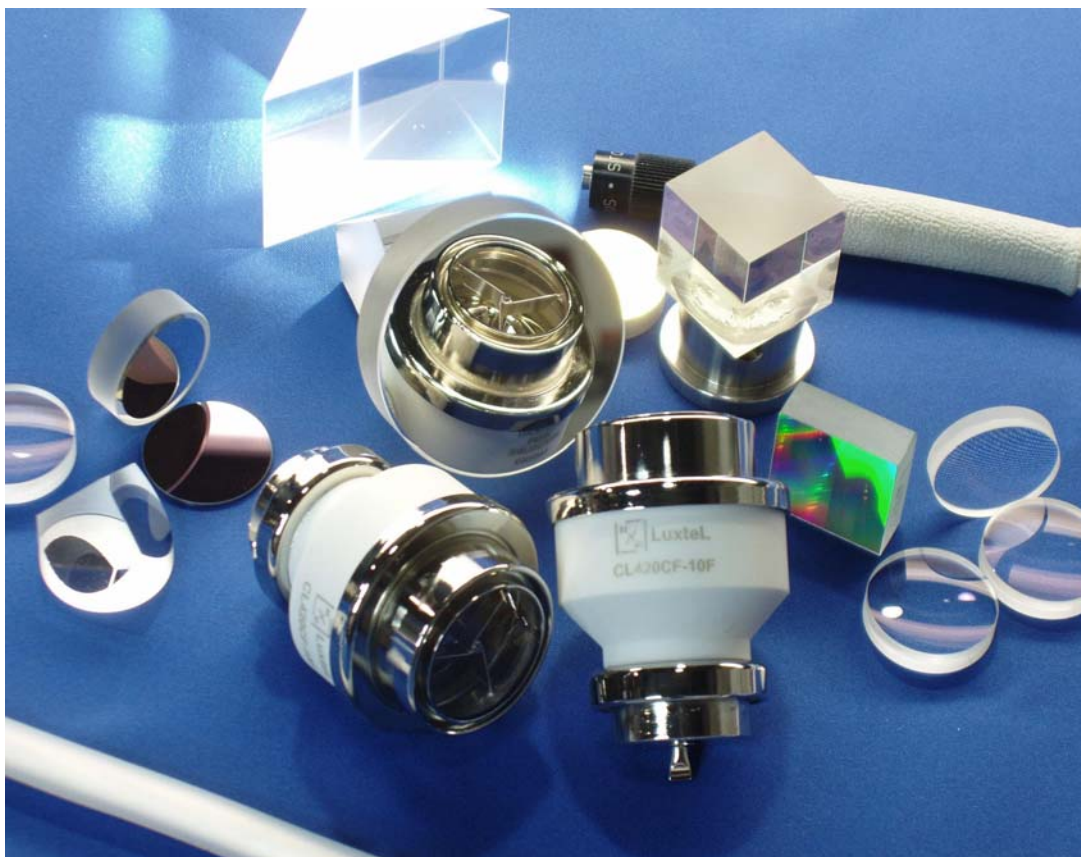

CeraLux Xenon Focused Arc Lamps With Elliptical Reflectors C Body Size



REFLECTOR SPECIFICATION

F 1.0
M = 1.2136
N = .7129

F 1.3
M = 1.3648
N = .7311

REFLECTOR EQUATION

$$1 = \frac{X^2}{M^2} + \frac{Y^2}{N^2}$$

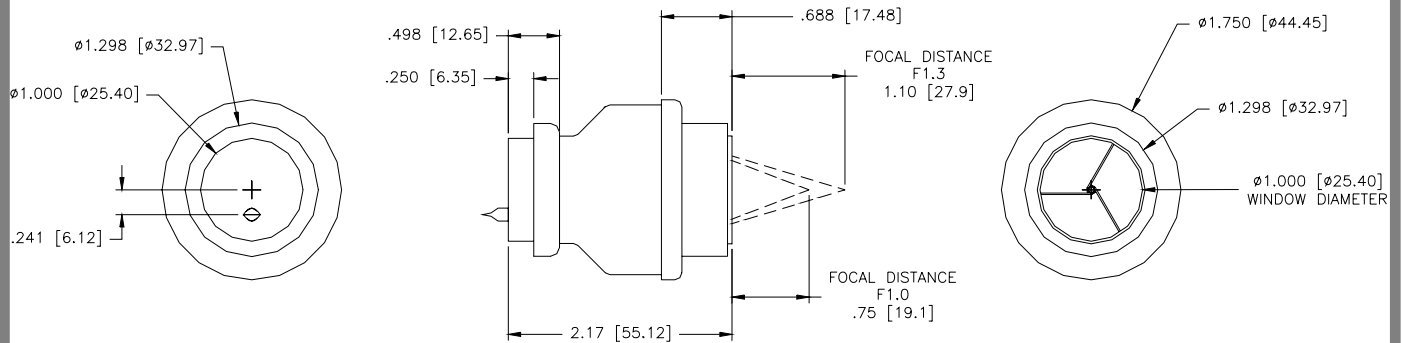

DIMENSIONS IN BRACKETS ARE IN MILLIMETERS

OPERATIONAL SPECIFICATIONS FOR STANDARD LAMPS

	CL300CF-10F	CL300CF-13F	CL500CF-10F	CL500CF-13F	CL700CF-10F	CL700CF-13F
POWER (watts)						
Nominal	300	300	500	500	700	700
Range	175-300	175-300	350-525	350-525	600-750	600-750
CURRENT (amps DC)						
Nominal	22	22	32	32	41	41
Range	13 - 23	13 - 23	23 - 35	23 - 35	35 - 45	35 - 45
VOLTAGE (volts DC)						
Nominal	14	14	16	16	17	17
Range	12-15	12-15	14-17	14-17	15-18	15-18
Minimum Ignition Voltage (kV)	23	23	23	23	23	23
OUTPUT AT NOMINAL POWER						
Radiant Output (watts)	75	75	110	110	190	190
Visible Output (lumens)	7400	7400	10000	10000	21000	21000
UV Output (watts)	4	4	5	5	8	8
IR Output (watts)	36	36	64	64	95	95
Color Temperature (°K)	5900	5900	5900	5900	5900	5900

All values and specifications are subject to change without notice.

Luxtel LLC 100 Ferncroft Road, Danvers, MA USA 01923 PH 978.774.9136 FAX 978.774.1559 e-mail: info@luxtel.net